



RESIDENTIAL IMPROVEMENT PERMIT APPLICATION

Building Department
25 LaGrange Street
Newnan, GA 30263
Ph. 770-254-2362 Fax 770-254-2361
Email – buildingplans@cityofnewnan.org



Subject Property

Address: _____

Number and Street

Subdivision

Contractor/Occupant Name and Contact #: _____

Name

Contact Phone Number

Type of Work:

- Detached Garage or shed greater than 120 square feet - *site plan and construction drawing required - including foundation – signed off by zoning*
- Addition or Attached Garage - *site plan and construction drawings required – including foundation – signed off by zoning*
- Alteration or Renovation that will not increase roof area or house footprint – *site plan not required*
- Basement Finish-Out

Gas Appliances in project area? yes no

Basement studs installed? yes no

Exterior walls currently insulated? yes no

Bathroom stubbed-up? yes no

Proposed bedrooms contain operable window or door that leads directly outside? yes no

Total square footage of improved area: _____ Estimated cost of project: _____

Is there an automatic sprinkler system in this house? yes no

Description of work:

Include a drawing of work to be done, showing all walls, windows, doors and gas appliances. Show all footing sizes, lumber sizing and spacing, beam dimensions and spans if they are used in your project. Dimensions must be shown and drawing shall be to scale, (a permit will not be issued without a drawing). A graph sheet and a nomenclature sheet are provided for your use.

I hereby certify that I am the owner occupant of subject property and HVAC, Plumbing and Electrical contractors are required to pull their own permits. I understand that I am to phone in all inspections for this project, and will be responsible for complying with all construction codes as adopted by the State of Georgia DCA.

Signature of Owner Occupant

Date



OCCUPIED OWNER AFFIDAVIT

Building Department
25 LaGrange Street
Newnan, GA 30263
Ph. 770-254-2362 Fax 770-254-2361
Email – buildingplans@cityofnewnan.org



Project Address _____

Owner's Name _____

The City of Newnan, in an attempt to satisfy requests from owners to perform work on owner-occupied property and in considering the safety and welfare of the general public, ask that you read and agree to each of the following statements before receiving a permit.

Please initial each statement:

1. I understand that as an owner-builder I must abide by all zoning ordinances in affect at the time of the permit application _____.
2. All construction must be in accordance to the construction codes at time of permitting as defined and adopted by the State of Georgia Dept. of Community Affairs _____.
3. I understand that the Building Official and the inspectors are not to design or provide professional building advice for this project _____.
4. I understand that the City of Newnan Building Department will not mitigate any contract disputes that may arise with sub-contractors _____.
5. I understand that if I compensate any person or company for work performed, they are required to have a business license, and HVAC, Plumbing, and Electrical contractors are to pull their own permits _____.
6. I understand that if any employed person gets injured on this project, they are entitled to workers compensation benefits _____.

I hereby certify that I am the owner occupant, have read and understand the above statements.

Signature of Owner Occupant

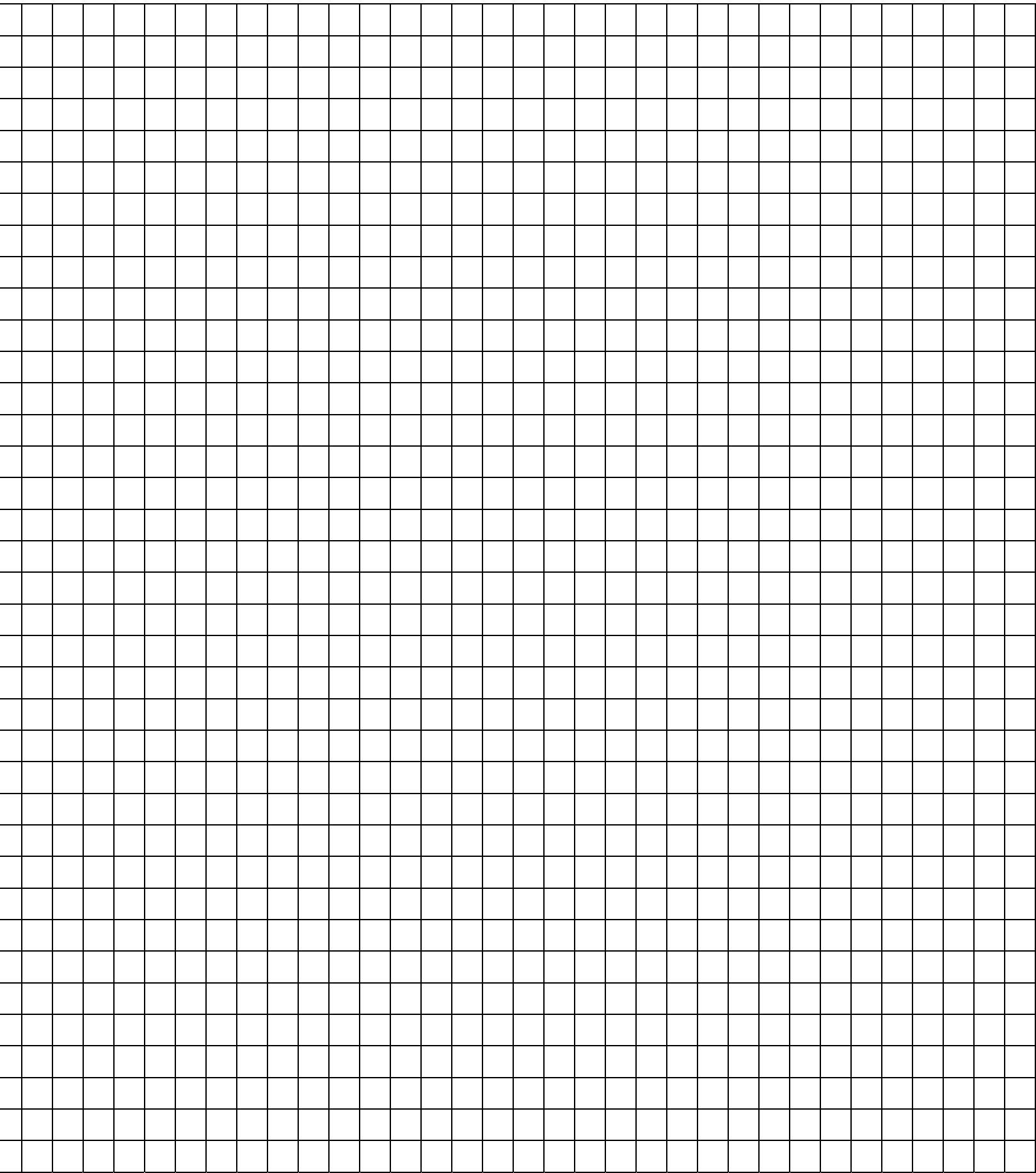

Nomenclatures

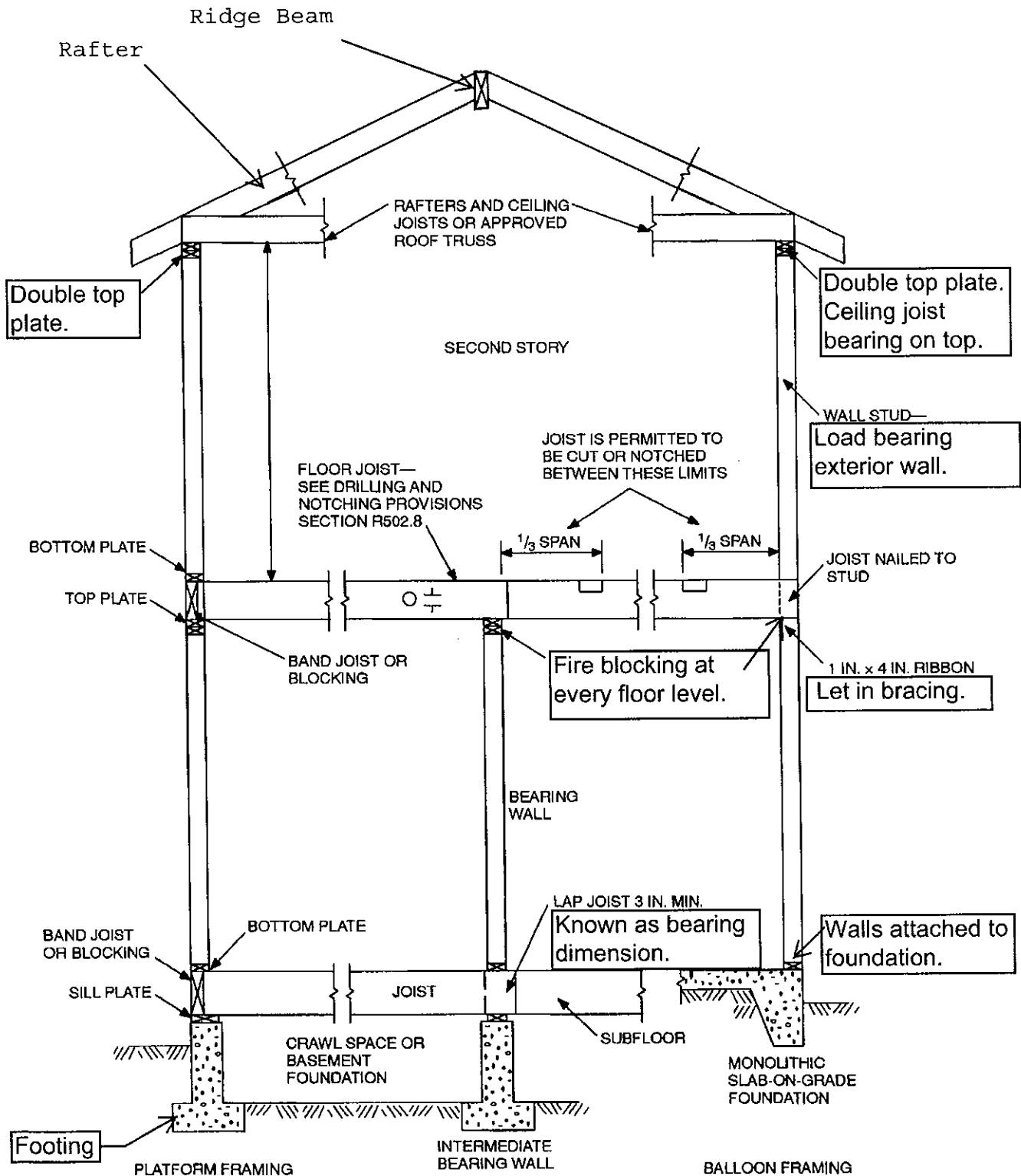

Drawing used for reference only, showing common framing terms.

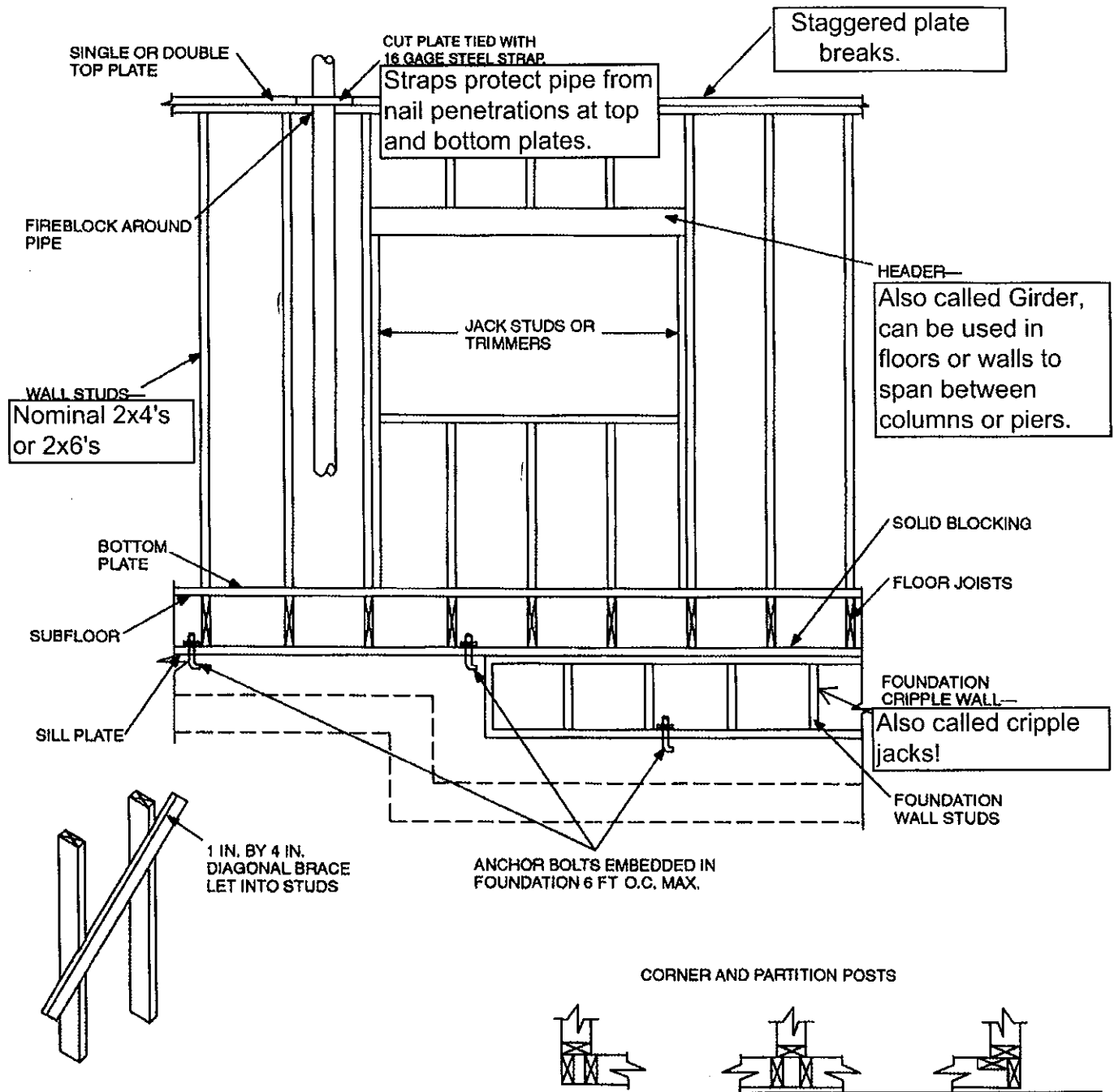

Drawings are for reference of framing nomenclatures only.

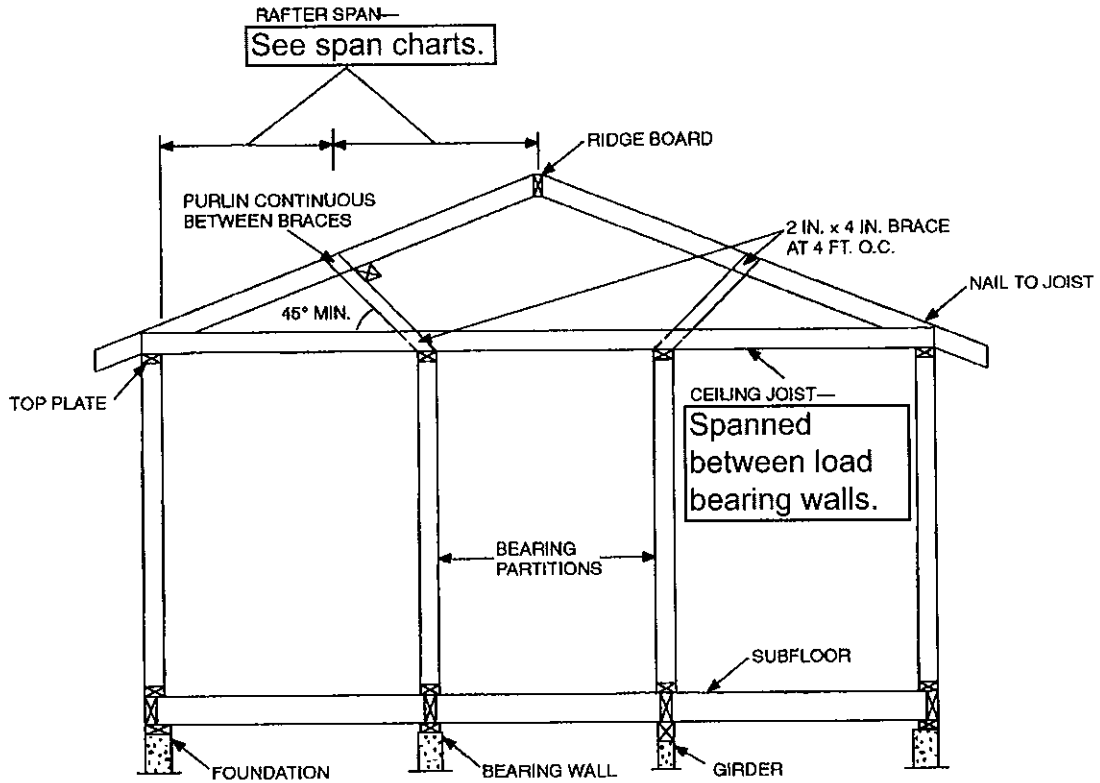

For SI: 1 inch = 25.4 mm, 1 foot = 304.8 mm, 1 degree = 0.018 rad.

NOTE: Where ceiling joists run perpendicular to the rafters, rafter ties shall be nailed to the rafter near the plate line and spaced not more than 4 feet on center

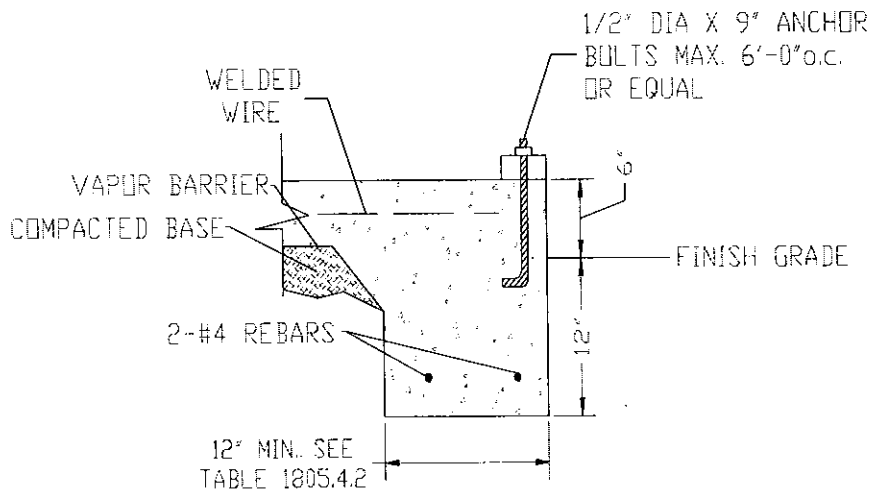

**PERIMETER FOOTER
(TYPICAL)**